



ESTATE AGENTS

It's who
you move
with.

London Road, Worcester, WR5 2JT

£425,000

5 2 2



Summary: This Victorian end terrace residence offers unexpectedly spacious living, coupled with the added convenience of off-road parking, a highly sought-after feature on London Road. This charming house is tastefully presented, yet still offers opportunity for personalization. Spread across three floors, it boasts generous living space catering to your family's every need, whether it's unwinding or hosting guests.

Description: As you approach the property, you will be greeted by a delightful front garden with a quaint clay tiled path leading to the front door. Upon entering, you will be welcomed by an internal porch adorned with a beautiful stained glass feature door. The hallway offers access to the lounge, dining room, kitchen, cellar, and stairs leading to the first floor. The cellar provides a great storage space. The lounge, positioned at the front of the property, boasts a stunning bay window. The sash-style windows, though double glazed, maintain the property's traditional charm. The lounge's burner, hardwood floors, picture rails, cornicing, and ceiling rose exude the allure of this fantastic space. The elegance of the ceiling rose and cornicing carries through to the dining room, featuring a striking fireplace and a large window, making it the perfect space for entertaining.

The kitchen is equipped with both wall and base units, tiled splashback, and plenty of work space, all providing ample preparation space for your culinary creations. The extended worktop acts as a breakfast bar with space for three stools is perfect for informal dining or socializing with guests while cooking. You'll also find an integrated oven, extractor fan, and a space for white goods making meal preparation a breeze. From the kitchen there is access to the rear garden and the shower room. The shower room is equipped with a shower, w/c and sink.

Ascending to the first floor, where you will find three of the bedrooms, a study, and the family bathroom. Bedroom three and the study are situated at the front of the property, while bedrooms two, five, and the family bathroom are located at the rear, providing a peaceful retreat. The bedrooms boasts stunning feature fireplaces and elegant picture rails, adding character to the space. The family bathroom is adorned with exquisite tiling and features a luxurious



London Road, Worcester

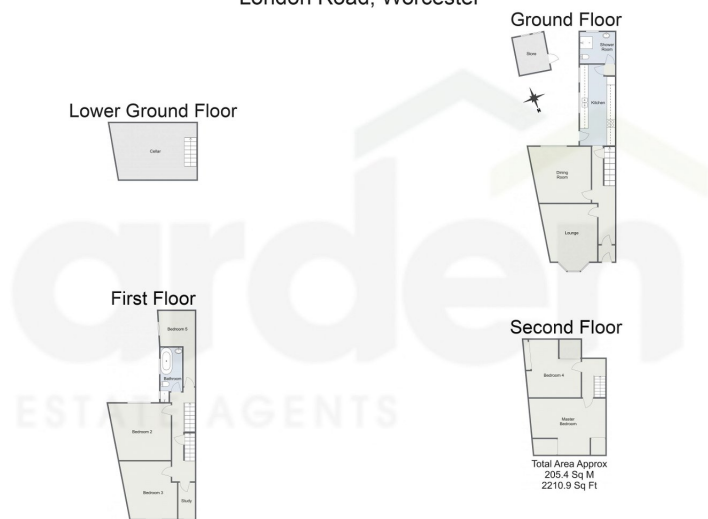

For illustrative purposes only. Decorative finishes, fixtures & fittings do not represent the current state of the property. Measurements are approximate & not to scale. Floor Plans made using RoomSketcher.

- End Of Terrace
- Off Road Parking
- Five Bedrooms Plus Study
- Bay Window
- Log Burner
- Convenient Location



For more information on this house or to arrange a viewing please call the office on:

01905 958 290

Alternatively, you can scan the QR to view all of the details of this property online.



arden
ESTATE AGENTS